

OMAC 320

TWO HEAD VERTICAL EDGE DYEING MACHINE



OMAC S.r.l

Via Germania 29 Z.I. Sud

35127 PADOVA

Tel. 049-8705227 - Fax 049-8707768

s/n

Year

Machine identification data and description:

Mod.: OMAC 320: Double head edge dyeing machine

s/n.:

Year:

Month:

General Description:

Machine for belt, leather goods, shoe factories and similar, used to dye leather strips, bag edges with shining ribbing, luggage and similar items. Machine is equipped with two straight, knurled rollers with diameter of 40mm and 20mm thickness. Groove shaped rollers can mounted and used for dyeing round edges. The dye batch can be continuously adjusted even when the machine is working.

Machine is fitted with:

- Two variable speed dc roller drive motor
- Color doser

The work cycle is controlled from a simple control panel that can be used in complete safety even when the machine is running.

Weight and dimensions:

Packing dimensions: W= 60 cm H= 35 cm D= 60 cm

Operating dimensions: W= 58 cm H=27 cm D= 50 cm

Gross weight (head only): 30 kg

Net weight (head only): 25 kg

Machine can be supplied with stand.

Dimension (complete): W= 58 cm H=111 cm D= 50 cm



NOTE: The type of packaging may vary according to the final destination.



Information on Noise:

During normal processing, the machine works continuously with a continuous background noise produced by the motor. The daily personal noise exposure for the operator therefore depends both on the rate of works and the amount of time he operates the machine.

The following maximum values were measured on the prototype examined at the maker's facilities:

All Positions: <70 dBA

Tone components: n.r.



NOTE: Measure were made with the machine in normal installation and operating conditions; the tone components were measured with 1/3 octave filters in compliance with ANSI Class III specifications.



Electrical specification:

Power input: Single phase 230V/50Hz, Class I earth circuit

Rated current: 1A @ 230V

The machine is protected by an automatic overload cut-out against over-current and short circuits deriving from faults in the internal power supply installation. This protection must not be considered as a substitute for the safety devices that the main power supply to which the machine is connected must possess.



NOTE: Before connecting the machine to the main power supply, always check that the main power supply voltage corresponds to the value stamped on the plate attached to the machine next to the power supply cable.



WARNING!

ONLY QUALIFIED PERSONNEL SHALL CONNECT THE MACHINE TO POWER SUPPLY IN COMPLIANCE WITH THE SAFETY REGULATIONS IN FORCE.

SPECIAL ATTENTION SHALL BE PAID CONNECTING THE MACHINE TO THE GROUND SYSTEM AND VERIFYING ITS PROPER FUNCTIONING.

Preliminary operations

Unpacking and Installation:

Machine is supplied packed in a cardboard box. Pick up the machine taking care to grasp it firmly at the bottom and resting it on your chest (the indications in Legislative Decree 626/94 on how to move loads manually should be followed), then place it on the sufficiently large work top. Make sure that work top is stable, horizontal and able to support the operating weight of the machine.

The machine installation site must be chosen so that there is enough free space around it; this may never be less than 50 cm on each side.



Connection to the main power supply:

The machine is supplied complete with a cable suitable for the type of power supply used, the plug must be fitted by qualified electricians if this operation is not carried out by OMAC technicians.



Using the machine

Before starting and using the machine, check all its components and remove the protective oil from its external mechanical parts. These operating may only be carried out with the machine disconnected from the main power supply.



Switching on and starting:

Press the black button on the control panel to give power and control circuits. (see below picture)



The green warning LED "TENSION" (Voltage) lights up on the control panel to show that the machine is powered. (see below picture)



Main adjustments:

1) Adjustment of color doser:

The color doser can be adjusted continuously, even when the machine is running, by turning the relative knob.

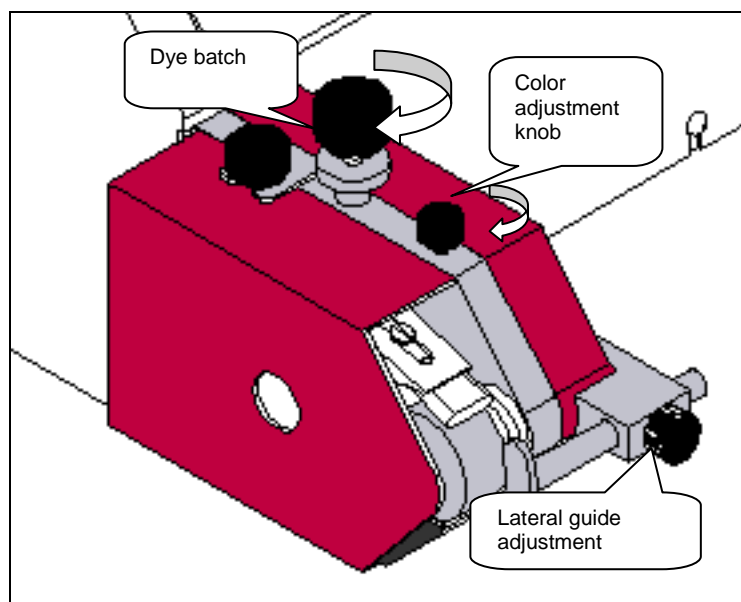

To adjust the position and pressure of the dye applicator brush, loosen the corresponding knob, manually adjust the position of the brush and tighten the knob once more..

2) Adjusting the lateral guide:

The machine is fitted with a handy lateral guide to make work easier; to adjust the position of the guide, loosen the horizontal knob, move the guide to the required position and tighten the knob once more.

3) Removing and cleaning the roller:

After every process, clean the roller, brush and tank by removing them and washing them thoroughly with water or a suitable solvent for the type of dye used.

To remove the roller, brush and tank proceed as follow:

- 1) Disconnect the machine from the power supply
- 2) Loosen the lock knob and turn the guard over to the side

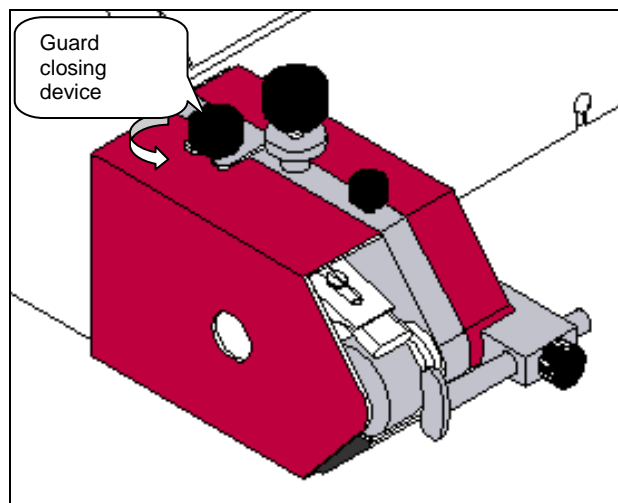

- 3) Unscrew the roller stop nut completely (box wrench n° 4) and remove the roller.
- 4) Loosen the stop screw of the brush and remove it.

To remount the pieces after washing, carry out the above operations in reverse order.



Machine operation:

After making the adjustments indicated in the previous chapter, the machine can start production; please remember; however, that machine reliability and long life depend on it being used appropriately for its characteristics and capacity, together with sufficient operator preparation.

Place the material to be processed on the dye applicator roller and run it through evenly.

Clean the roller, brush and tank from dye residues after every process. Substitution due to damage or excessive wear must be carried out by authorized OMAC S.r.l technicians.





Warning and Information on safety devices

The OMAC Mod. 320, edge dyeing machine is fitted with two operator safety systems:

1. Integral protection of the work area with a safety micro switch that blocks the machine when it is opened
2. emergency stop button.



If the machine should work irregularly, stop using it Immediately and contact the Omac service center; users may not carry out any maintenance operations except for normal cleaning of machine part when necessary, as described above.

Use a clean damp cloth and just a little detergent if necessary to clean to clean metal surfaces; never use petrol, turpentine or other solvents. Please remember that the Law severely punishes those who modify or tamper with the machine causing its level of safety to be reduced.

Contents:

- Machine Identification data and description: pag. 2
- Weight and dimensions: pag. 2
- Information on noise: pag. 3
- Electrical specifications: pag. 3

Preliminary operations

- Unpacking and installation: pag. 4
- Connections to the main power supply: pag. 4

Uso della Macchina

- Switching on and starting: pag. 5
- Main adjustment: pag. 6
- Adjustment of dye batch pag. 6
- Adjustment of lateral guide pag. 7
- Removing and cleaning the roller pag. 7
- Main operations: pag. 8

Warnings and Information on safety device: pag. 9

Index:

- Electric diagram
- Spare parts list

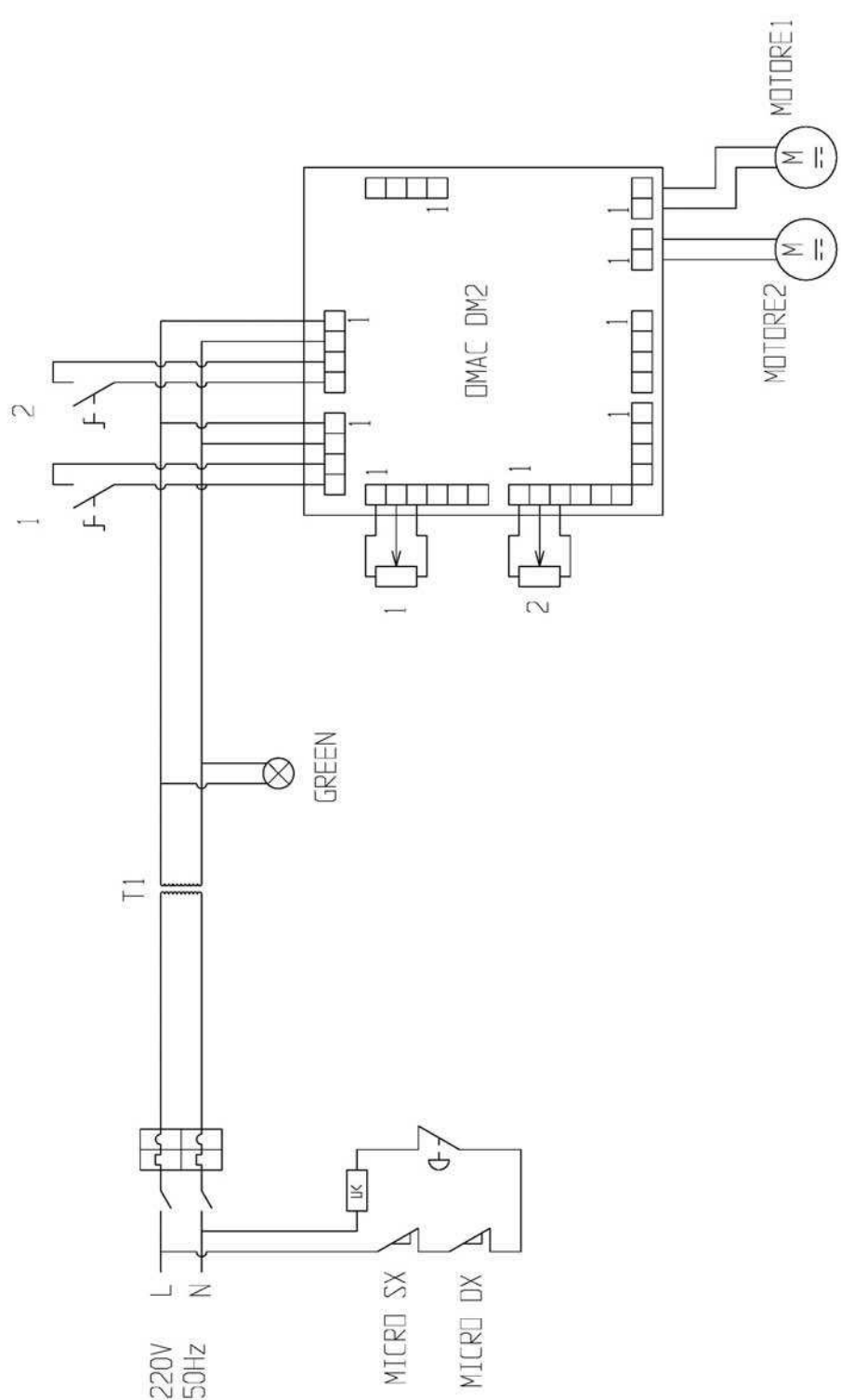

INTERRUTTORE GENERALE: 0.6 ~ 1 A REGOLATO 0.6A
T1: 200VA IN 220V OUT 24V
POTENZ/OMETRO VELOCITA': 2400m
MOTORE: 24V 70W
SCHEDA DMAC DM2

AGGIORNATO:		DISIGNATO DA:	
		FILIPPO	
MME SRL			
DENOM. SCHEMA ELETTRICO			
MOD 320 325			
Toll. Gen. ± 0.1		N. PZ. X	REV
Rugosità 12.5/ 3.2/		UNG. NU. Particolare	
COLORE: X		MAT. X	DATA X
TRATT. X			

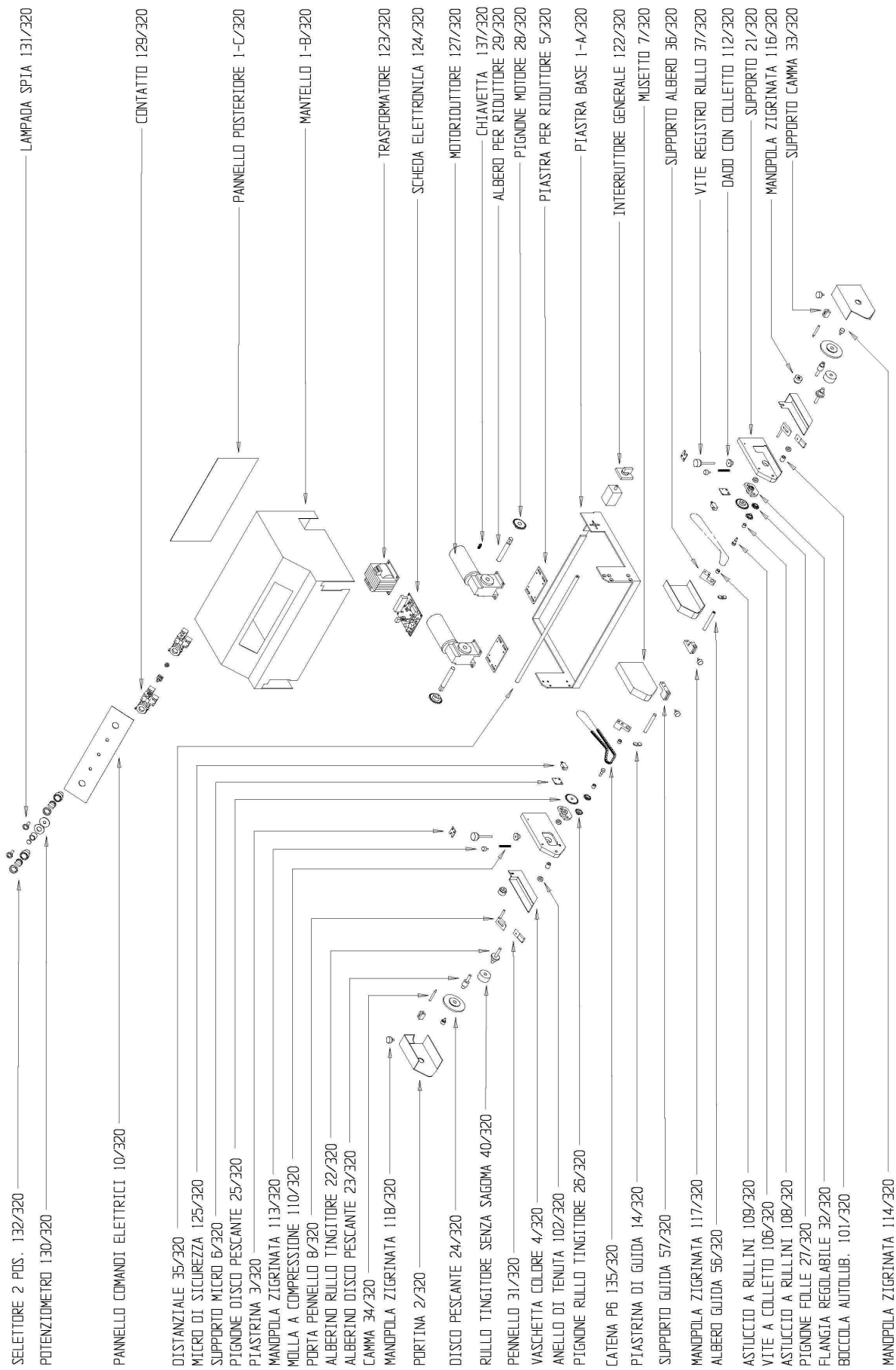

OMAC SRL	Mod. Macc.	Tavola N
	MODELLO 320	1
Esplosione dei pezzi di ricambio		
DATA: 06-05-99		